

swissôtel QUITO

THE PERFECT BASE FROM
WHICH TO EXPLORE THIS
WORLD HERITAGE CITY



A MARK OF DISTINCTION

THE FINEST IN SWISS HOSPITALITY
RESPECTED THROUGHOUT THE WORLD

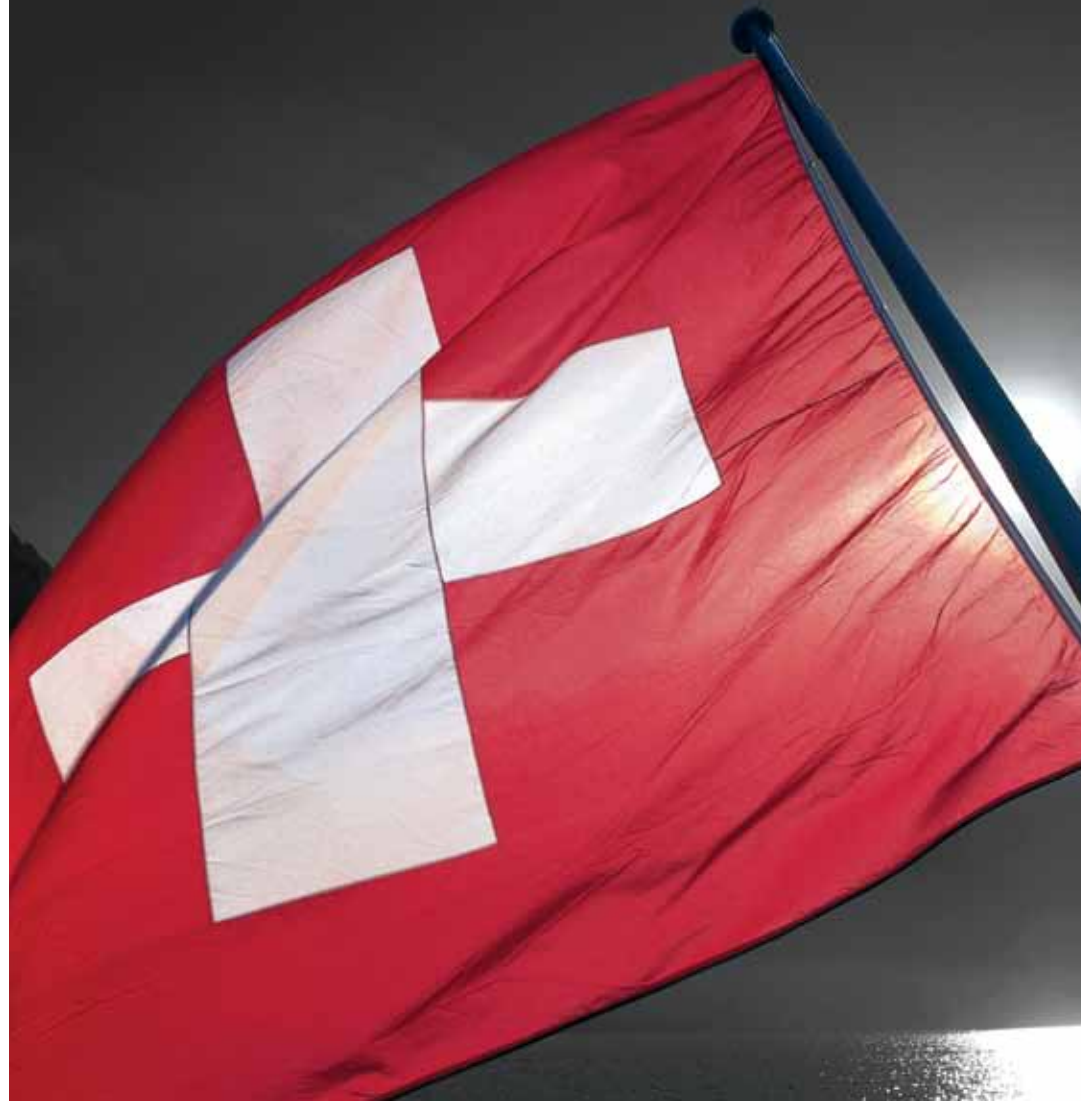

Switzerland is synonymous with quality, reliability and hospitality and these attributes are also an intrinsic part of our culture ensuring that no matter which hotel you visit we represent all that is positive about Swissness.

- Excellent Quality
- Genuine Hospitality
- Intuitive Reliability





EVERYTHING YOU NEED,
AND SOME THINGS YOU HADN'T THOUGHT OF.
AND THAT'S JUST
IN YOUR ROOM.

SWISSÔTEL QUITO

The capital of Ecuador, Quito is located 2800 metres above sea level. In November of 1978, Quito was declared by UNESCO as 'Cultural Heritage of Humanity'. Just 22 kilometers south of the equator, Quito is the center of a world of wonders.

30 years since becoming the first world heritage city Quito combines the modern with historic and is surrounded by the magnificent Andes. Nearby Quito, beautiful landscapes in the countryside can be discovered, including volcanoes and national parks. Quito is also the gateway to explore the Amazon and the Galapagos Islands. Swissôtel Quito is a luxury hotel conveniently located in the commercial and residential area of the city. Marvel at the inspiring views of

Cotopaxi and Pichincha volcanoes from the comfort of your hotel. Explore the architectural jewels of the nearby colonial sector, or venture out into the local countryside to see charming haciendas and native markets. Located just minutes from Mariscal Sucre International Airport, in the city's most prestigious and safe area, our hotel is close to great shopping, fascinating museums and the bustling financial district.

WORLD CLASS COMFORT

You will find that as part of Swissôtel Hotels & Resorts our hotels are not just facades and interiors but the embodiment of contemporary design – uncluttered, understated and modern and that our service is not only efficient, but intuitive, charming and warm.

DISCOVER

Quito is home to one of the most extensive colonial districts in Latin America with numerous architectural and cultural attractions. An authentic treasure in the Andes, Quito is an incomparable city resplendent with colonial architecture full of old churches, squares and colonial museums.



ACCOMMODATION

Swissôtel Quito offers 232 oversized guestrooms and suites and 43 Executive Apartments, all furnished with modern European elegance and Swiss bedding. Our guests appreciate our Swiss Business Advantage Room, featuring a large and ergonomic work area, high speed internet and cable TV.

Our Swiss Suites include access to our executive lounge with a complimentary light buffet served at meal times, drinks from 8.30pm - 10.30pm and a valet service and hostess service.

INDULGE

Relax or rejuvenate at our Spa & Sport centre where you can choose from a variety of treatments and therapies from around the world. Other recreational amenities at our hotel include an aerobic room, fitness equipment, indoor/outdoor swimming pool, racquet, squash and tennis court.

DINING & ENTERTAINMENT

Dinning at Swissôtel Quito promises to be an amazing international experience. Enjoy the best cuts of meat, at Prime Rib Steak House, or sushi, tempura, teppanyaki and other Japanese favorites at Tanoshii restaurant. Sample Ecuadorian cuisine at lavish breakfast and lunch buffets or have a proper afternoon tea at Café Quito.

Our restaurant Les Alpes, presents Swiss delicacies with an alpine flair, and our fifth restaurant, Time Out Sports Bar and Grill offers the best in casual American food. At the end of the day, relax with a cocktail in bar Le Point, while enjoying live music in a cozy and pleasant atmosphere.



CONFERENCES & EVENTS

Elegant décor combines with sophisticated audiovisual equipment to create a productive and inviting atmosphere for your meeting. Function rooms range from the Geneve which seats 12 people in a classroom-style to the St. Moritz, which holds up to 1200 persons in a reception configuration.

Swissôtel Quito has a total of 18 meeting rooms with state-of-the-art equipment. Our business center is equipped with computer workstations, internet access, laser printer, color printer, full secretarial service, board rooms and furnished offices.

Whether you are planning a festive cocktail reception or a corporate dinner and lecture, we enhance your event with the outstanding service and creativity of our banquet staff. We offer two ballrooms, which can be divided independently into six meeting rooms to serve receptions from 100 to 1500 people.

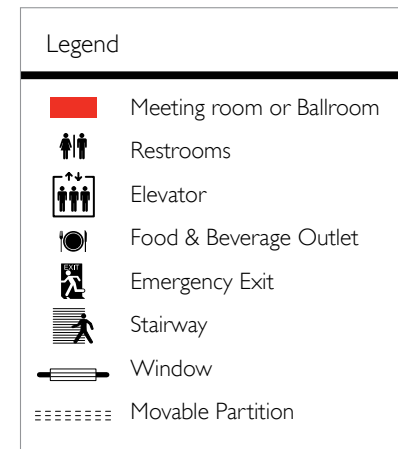
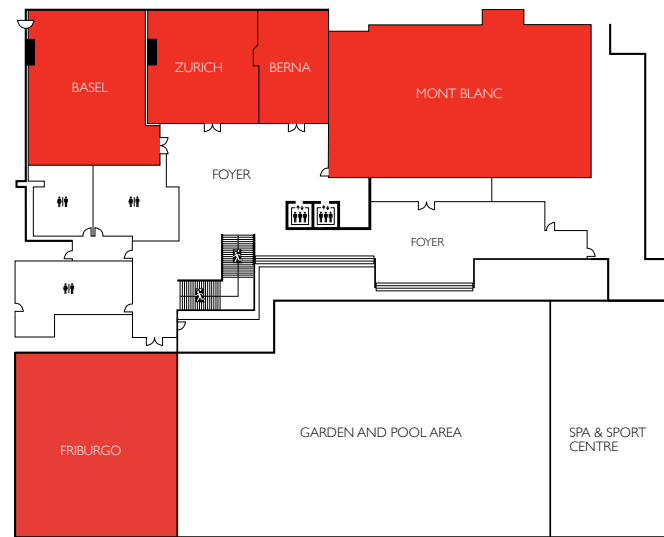
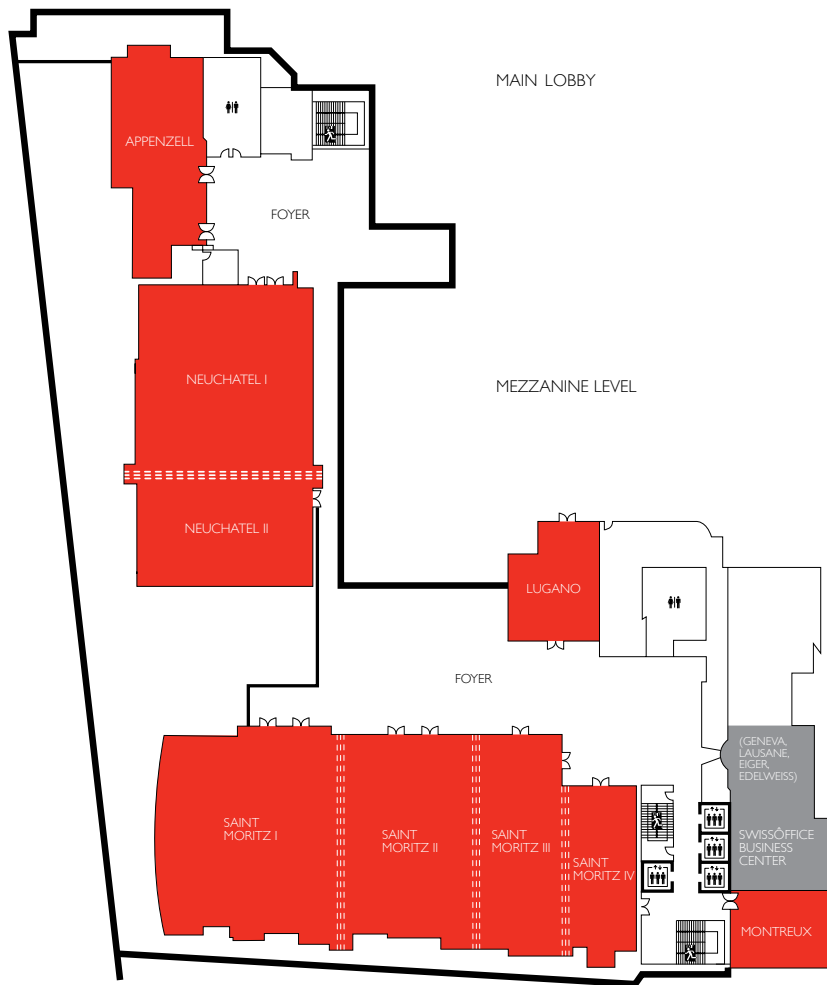

CAPACITY CHART

NAME OF MEETING ROOMS	AREA FT2	AREA M2	L	W	H	THEATRE STYLE	CLASSROOM	BANQUET	BOARDROOM	SQUARE	ROUND	U-SHAPE	RECEPTION/ COCKTAIL	
St Moritz	10338.52	960.48	46.40	20.70	6.20	1100	750	900	N/A	N/A	700	135	1500	
St Moritz I	3443.59	319.92	18.60	17.20	5.90	350	225	300	N/A	N/A	250	80	400	
St Moritz II	2855.88	265.32	19.80	13.40	6.20	280	135	220	N/A	N/A	150	60	300	
St Moritz III	1871.63	173.88	20.70	8.40	5.90	120	95	120	N/A	N/A	100	40	150	
St Moritz IV	1317.83	122.43	15.90	7.70	5.90	100	65	100	30	N/A	60	30	100	
Montreaux	1073.70	99.75	10.50	9.50	3.20	60	40	60	25	35	50	25	60	
Neuchatel	5429.85	504.45	29.50	17.10	4.70	600	400	450	N/A	N/A	380	100	800	
Neuchatel I	3423.57	318.06	18.60	17.10	4.70	300	215	250	N/A	N/A	180	60	350	
Neuchatel II	2024.69	188.10	11.00	17.10	4.70	250	120	180	40	50	140	40	200	
Appenzell	1650.54	153.34	18.70	8.20	4.10	120	70	120	30	40	100	45	120	
Basel	1114.06	103.50	11.50	9.00	3.10	80	50	80	20	25	60	35	80	
Zurich	731.95	68.00	8.50	8.00	3.20	40	25	40	15	20	30	20	40	
Berna	603.86	56.10	8.50	6.60	3.10	20	20	10	15	20	12	20	20	
Mont Blanc	2532.96	235.32	21.20	11.10	3.00	240	120	240	N/A	N/A	200	80	300	
Lugano	766.39	71.20	8.90	8.00	2.70	60	40	30	20	20	20	25	70	
Geneve	290.41	26.98	7.10	3.80	3.00	N/A	15	15	10	15	10	10	25	
Lausanne		Fixed Set Up Board Rooms								8				
Eiger		Fixed Set Up Board Rooms								8				
Edelweiss		Fixed Set Up Board Rooms								12				
Friburgo	1529.2	142.14	15.45	9.20	3.80	110	60	100	30	30	80	40	120	

