

Switzerland is synonymous with quality, reliability and hospitality and these attributes are also an intrinsic part of our culture ensuring that no matter which hotel you visit we represent all that is positive about Swissness.

- Excellent Quality
- Genuine Hospitality
- Intuitive Reliability



FOR PROMOTIONS AND SPECIAL PACKAGES
AT SWISSÔTEL HOTELS & RESORTS WORLDWIDE,
PLEASE VISIT WWW.SWISSOTEL.COM



swissôtel THE HOWARD
LONDON

Temple Place, London, WC2R 2PR, United Kingdom
Tel +44 20 7836 3555 Fax +44 20 7379 4547
Email london@swissotel.com www.swissotel.com/london

swissôtel THE HOWARD
LONDON

OUTSTANDING RIVERSIDE
SETTING, ENJOYING THE BEST
VIEWS ACROSS LONDON'S
HISTORIC SKYLINE



A MARK OF DISTINCTION

THE FINEST IN SWISS HOSPITALITY
RESPECTED THROUGHOUT THE WORLD



EVERYTHING YOU NEED,
AND SOME THINGS YOU HADN'T THOUGHT OF.
AND THAT'S JUST
IN YOUR ROOM.

SWISSÔTEL THE HOWARD, LONDON

The five-star hotel is set in a quiet oasis just off the Embankment. The hotel enjoys a postcard panoramic view of the River Thames from the Houses of Parliament to St. Paul's Cathedral.

It is located on the cusp of the financial district, and just a short stroll will take you to the West End and Covent Garden with its bars, restaurants and shops. So whether you are here for business or pleasure, Swissôtel The Howard, London has the best location.

The hotel boasts 189 rooms overlooking either the River Thames or its own Garden Courtyard. Twelve luxury suites are located on the top floors of the hotel, all with either a private balcony or a terrace with outstanding views of the river and its magnificent landmarks. Enjoy wide screen TV, CD and DVD players, and in the bathroom the luxury of separate bath, shower and VIP amenities.

COMFORT

You will find that as part of Swissôtel Hotels & Resorts our hotels are not just facades and interiors but the embodiment of contemporary design – uncluttered, understated and modern and that our service is not only efficient, but intuitive, charming and warm.

DISCOVER

Located in the heart of London, famous sights such as Big Ben, the London Eye and Covent Garden with its lively markets, shops and dining are just footsteps away. Many theatres are situated nearby showing world-famous musicals 'The Lion King' or 'Chicago'. The Royal National Theatre and the Royal Philharmonic Hall sit on the beautiful South Bank across from the hotel.



DINING & ENTERTAINMENT

12 Temple Place Restaurant, 'Home of modern British cuisine' can sit 50 persons inside and another 50 in the Garden Courtyard where guests can enjoy al fresco dining surrounded by waterfalls and plant life to create a serene dining experience.

The cuisine is modern British and concentrates on using only the freshest local ingredients. The Executive Chef focuses on combining traditional British recipes with modern innovations into seasonally changing dishes.

Temple Bar, is adjacent to the Garden Courtyard and is the perfect place for a business or casual conversation, complemented by a glass of aged whisky or refreshing cocktail.

Mauve, the cosmopolitan dining bar, serves seasonal afternoon tea, light meals during the day and Champagnes as well as cocktails during the evening.



CAPACITY CHART

NAME OF MEETING ROOMS	AREA FT ²	AREA M ²	L	W	H	THEATRE STYLE	CLASSROOM	BANQUET	BOARDROOM	SQUARE	BUFFET	U-SHAPE	RECEPTION/COCKTAIL
Fitzalan Suite	1431	132.8	22.90	5.80	2.60	120	60	120	60	63	80	60	200
Fitzalan I	680	63.2	10.90	5.80	2.60	60	30	50	30	28	40	25	80
Fitzalan II	753	69.60	12.00	5.80	2.60	60	30	50	30	28	40	25	80
Arundel Suite	1253	116.5	18.50	6.30	2.30	100	50	80	36	48	50	45	100
Arundel I	645	56.7	9.00	6.30	2.30	50	20	40	18	23	30	20	40
Arundel II	644	59.85	9.50	6.30	2.30	50	20	40	18	23	30	20	40

GROUND LEVEL

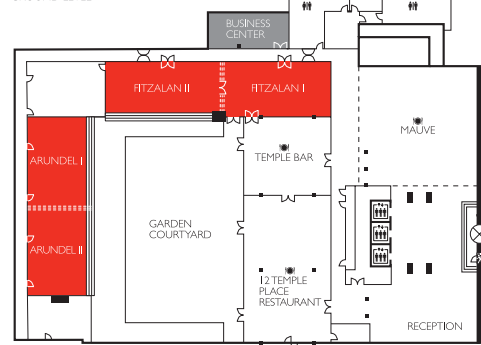

CONFERENCES & EVENTS

No detail is too small to ensure that your event is a resounding success. Our two elegantly appointed Fitzalan and Arundel Suites can cater for up to 120 people. Both suites enjoy natural daylight and can be divided into two smaller suites. The suites are air-conditioned, and are equipped with state-of-the-art audio visual and lighting technology, which will enhance any event to the highest standard.

With London's historical venues at your feet you can enjoy views that take your breath away. Experience a private ceremony, a cocktail reception or a private dining event on one of the rooftop Terrace Suites with the capacity for up to 60 people. A private butler and a violinist might just be the finishing touches to your perfect event.

At Swissôtel The Howard, London, you will have a dedicated Conference and Events Organiser who will work with you from the beginning to the end of your event, to ensure that all of your expectations are met and exceeded.



ACCOMMODATION

Luxuriously appointed rooms and suites offer spacious working desks with WiFi high-speed internet access, ergonomic chair, three direct-dial telephones with voicemail, complimentary Lavazza espresso machine, extensive tea station, bathrobes, safety deposit boxes, hairdryers, iron and ironing board, a selection of luxury bath and body products, in-room entertainment and air-conditioning.

INDULGE

Enjoy the tranquillity and pampered comfort expected from a five-star hotel, with each room fitted with accessories necessary for business and leisure travellers. Complimentary access for all guests is provided to a luxury health club, Virgin Active located just five minutes walk from the hotel and offers studio classes, an extensive gym, a 20 metre swimming pool and a number of spa treatments.

