

swissôtel BERLIN

AM KURFÜRSTENDAMM

EXCEPTIONAL: A FABULOUS
VIEW OVER THE KURFÜRSTENDAMM
AND ITS OWN ART COLLECTION
IN THE LOBBY



A MARK OF DISTINCTION

THE FINEST IN SWISS HOSPITALITY
RESPECTED THROUGHOUT THE WORLD

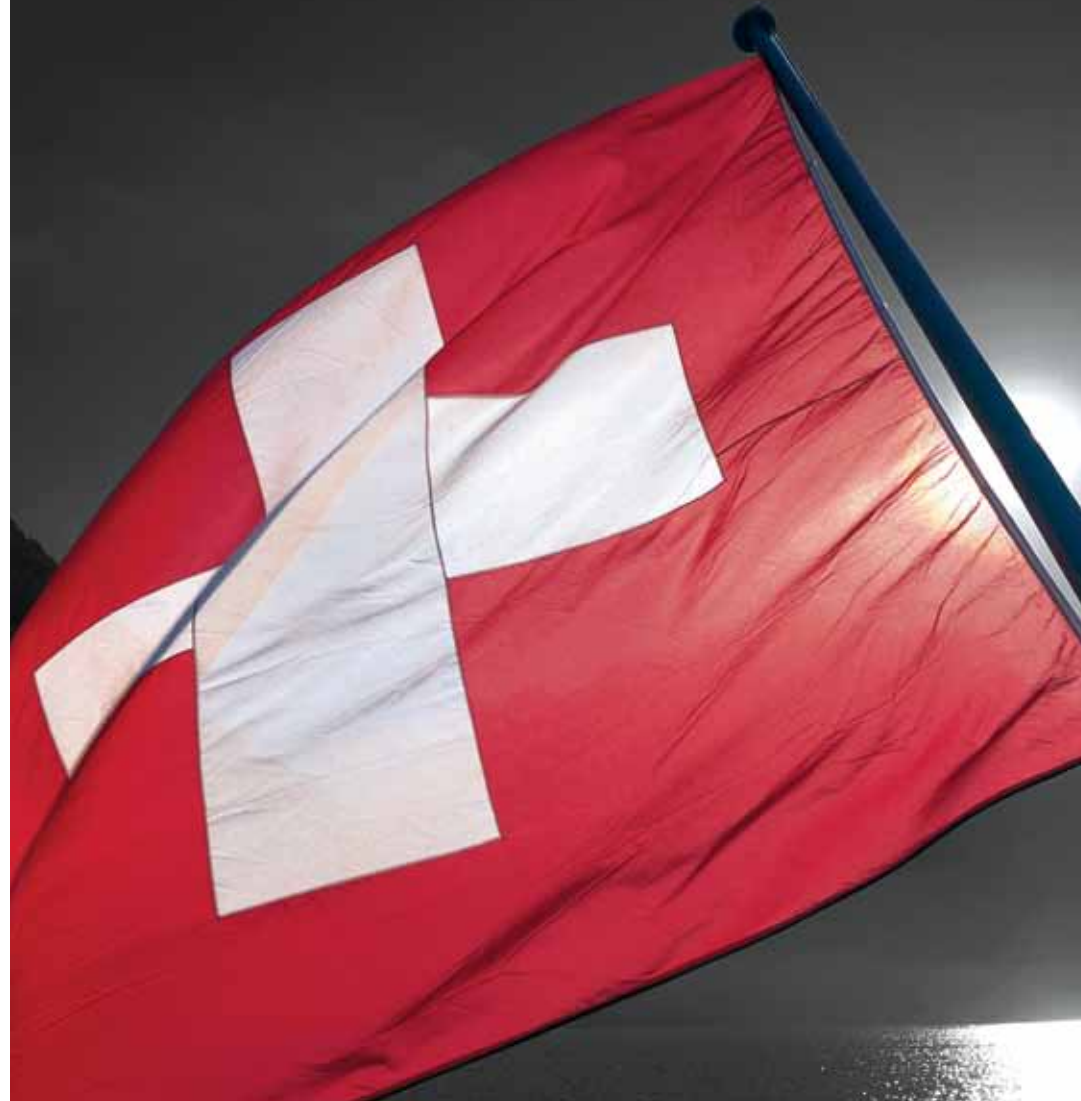

Switzerland is synonymous with quality, reliability and hospitality and these attributes are also an intrinsic part of our culture ensuring that no matter which hotel you visit we represent all that is positive about Swissness.

- Excellent Quality
- Genuine Hospitality
- Intuitive Reliability





ENJOY THE BEST OF SWISS HOSPITALITY
AND WE WILL MAKE
YOU FEEL AT HOME.

SWISSÔTEL BERLIN

On entering the calm, daylight filled lobby of Swissôtel Berlin you will leave all the commotion of the city centre behind and enter a space of understated tranquility. The hotel guarantees a superlative experience with modern architecture and a remarkable private collection of contemporary German art.

Swissôtel Berlin is an elegant and modern hotel in the heart of Berlin. Located on Germany's most famous shopping boulevard, the Kurfürstendamm, you can enjoy splendid views from our highly reputable dining venue Restaurant 44 and some of our guest bedrooms. Less than 10 kilometres from Tegel airport, the hotel is close to renowned Berlin attractions including the Memorial Church, trade and exhibition centre Messe Berlin and ICC, art galleries and museums as well as Europe's largest department store, the KaDeWe.

At Swissôtel Berlin we provide you with everything you need to ensure a relaxing city centre stay: a 24-hour in-house fitness facility where you can rejuvenate, an underground garage with direct access to the hotel and if you wish to explore the city by public transport or visit surroundings museums or theatres, our concierges will be pleased to assist with any enquiry you may have.

Certified: ISO 9001, OHSAS and ISO 14001 underlining the hotels commitment towards supporting the local community and protecting the environment.

WORLD CLASS COMFORT

You will find that as part of Swissôtel Hotels & Resorts our hotels are not just facades and interiors but the embodiment of contemporary design – uncluttered, understated and modern and that our service is not only efficient but intuitive, charming and warm.

DISCOVER

Berlin is a vibrant cosmopolitan metropolis with a rich cultural history. The Kurfürstendamm with its landmark, the Memorial Church, is at the very centre of City West and unites the traditional Berlin of the past with the state-of-the-art contemporary city that it has become, with buildings from the 20's sitting shoulder to shoulder with modern glass palaces.

The public transportation network is excellent and easily accessible. The Messe Berlin trade and exhibition centre, main train station Hauptbahnhof and the airport Tegel are just a few minutes by taxi.



ACCOMMODATION

In our 316 modern rooms our guests appreciate the convenience of wireless LAN, DSL Internet connection, complimentary SKY Entertainment Program, LCD TV's as well as a personal coffee maker. Each guest room is also equipped with a good sized bathroom with shower and bath tub and an ironing board ingeniously hidden behind the large wall mirror.

INDULGE

Located within Swissôtel Berlin is Restaurant 44, where you can enjoy flavours and aromas that will set a very high standard for your future culinary events. With excellent service and a relaxing and contemporary ambience a visit to Restaurant 44 is a must. If you choose to stay in the privacy of your guest room, our 24 hours in-room service provides a comprehensive selection of great food and drinks.

DINING & ENTERTAINMENT

The Grande Galerie is the perfect place to start the day with a coffee and croissant or to relax in the evening with light snacks and a drink, alternatively unwind in the casual ambience of the Palermo Bar.

Indulge all the senses at Restaurant 44. With a great view over the Kurfürstendamm this modern, elegant dining environment invites guests to enjoy the aromatic delicacies of our young, creative chef, Danijel Kresovic.

The terrace with its herb garden is a special location for a daytime lunch and the illuminated boulevard provides a lovely backdrop for a special dinner. Our herb garden is home to a vast range of exotic herbs including purple chilli from Ecuador and many varieties of basil from around the world.



CONFERENCES & EVENTS

No matter if you have a small meeting or large conference; our facilities include nine daylight-flooded conference rooms for up to 100 participants and Berlin's only ballroom with a view over the Kurfürstendamm for up to 350 guests.

The ballroom with its wooden floor and ceiling height of over 6 metres is a very special location for every kind of festivity and conference. State-of-the-art audio-visual systems are standard and the Swiss Business Corner is offering complimentary internet access to all guests.

The Cooking Studio 44 is a hub of innovation and creativity. Equipped with the latest kitchen appliances, the studio is the perfect venue for team building events, incentives or a unique end to a successful conference for 10 to 12 people.

CAPACITY CHART

NAME OF MEETING ROOMS	AREA FT2	AREA M2	L	W	H	THEATRE STYLE	CLASSROOM	BANQUET	BOARDROOM	SQUARE	ROUND	U-SHAPE	RECEPTION/ COCKTAIL
Ku'damm I	1884	175	10	17	6	140	80	100				40	150
Ku'damm II	2045	190	11	17	6	120	70	100				40	150
Ku'damm I & II	3929	365	21	17	6	350	210	230					350
Foyer	2476	230	18	13	3			160					200
Lüpertz	883	82	11	7	3	50	40	50	20	20		22	60
Knoebel	603	56	10	6	3	35	20	40	18	18		14	40
Foerg	398	37	8	5	3				12	12			
Kirkeby	398	37	8	5	3				12	12			
Höckelmann	398	37	8	5	3				12	12			
Federle	398	37	8	5	3				12	12			
Immendorff I	754	70	8	9	3	50	34	40	18	18		20	50
Immendorff II	754	70	8	9	3	50	34	40	18	18		20	50
Immendorff III	754	70	8	9	3	50	34	40	18	18		20	50
Immendorff I & II or II & III	1508	140	16	9	3	100	50	70				36	100
Immendorff I, II & III	2262	210	24	9	3	150		120					150

MEZZANINE LEVEL
(HALF FLOOR ABOVE LEVEL 3)

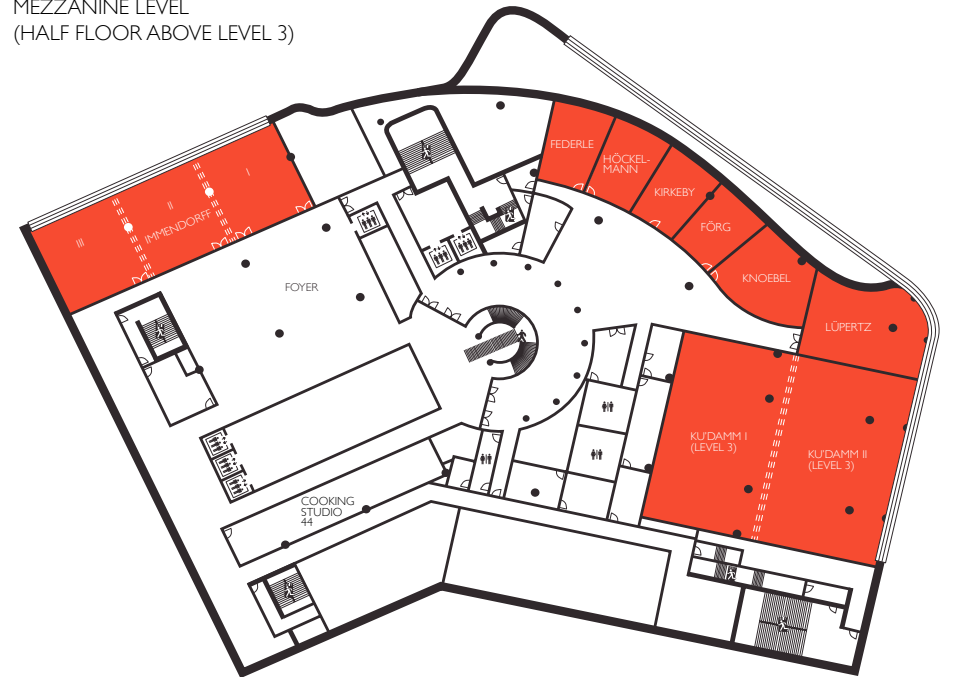
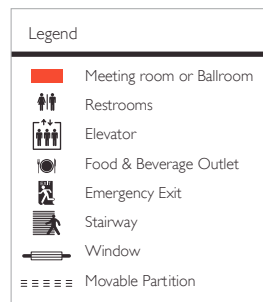

FOR PROMOTIONS AND SPECIAL PACKAGES
AT SWISSÔTEL HOTELS & RESORTS WORLDWIDE,
PLEASE VISIT WWW.SWISSOTEL.COM

GENEVA
SYDNEY
TALLINN
CHINA
LONDON
ZÜRICH
SINGAPORE
SHANGHAI
AMSTERDAM
ISTANBUL
THAILAND
MOSCOW
BERLIN
GERMANY
JAPAN
QUITO
USA
SWITZERLAND
LIMA
TURKEY

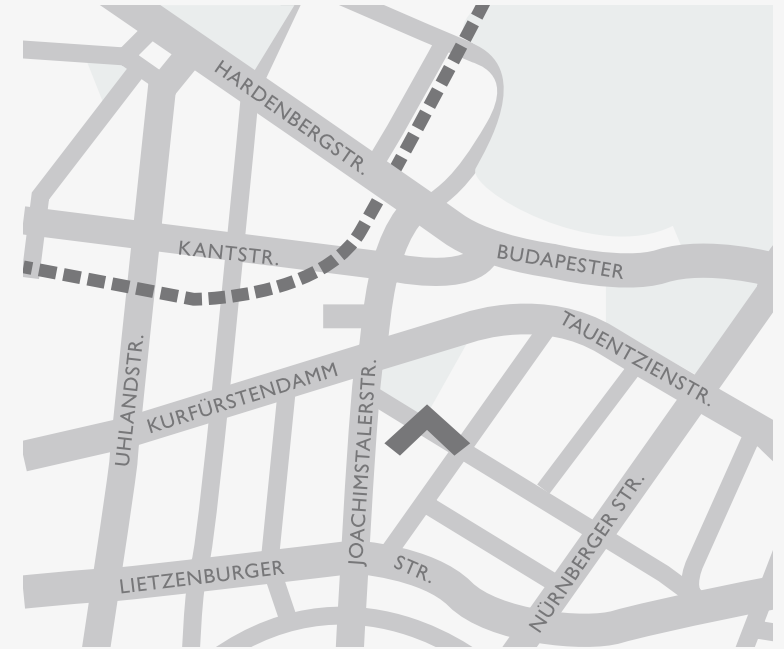

swissôtel BERLIN
AM KURFÜRSTENDAMM



Am Kurfürstendamm, Augsburger Strasse 44

10789 Berlin, Germany

Tel +49 30 220 10 0 Fax +49 30 220 10 2222

Email berlin@swissotel.com www.swissotel.com/berlin